

**PROPOSED PARKING LOT**  
(WEST OF FIRE STATION)  
SCALE: 1"=10'

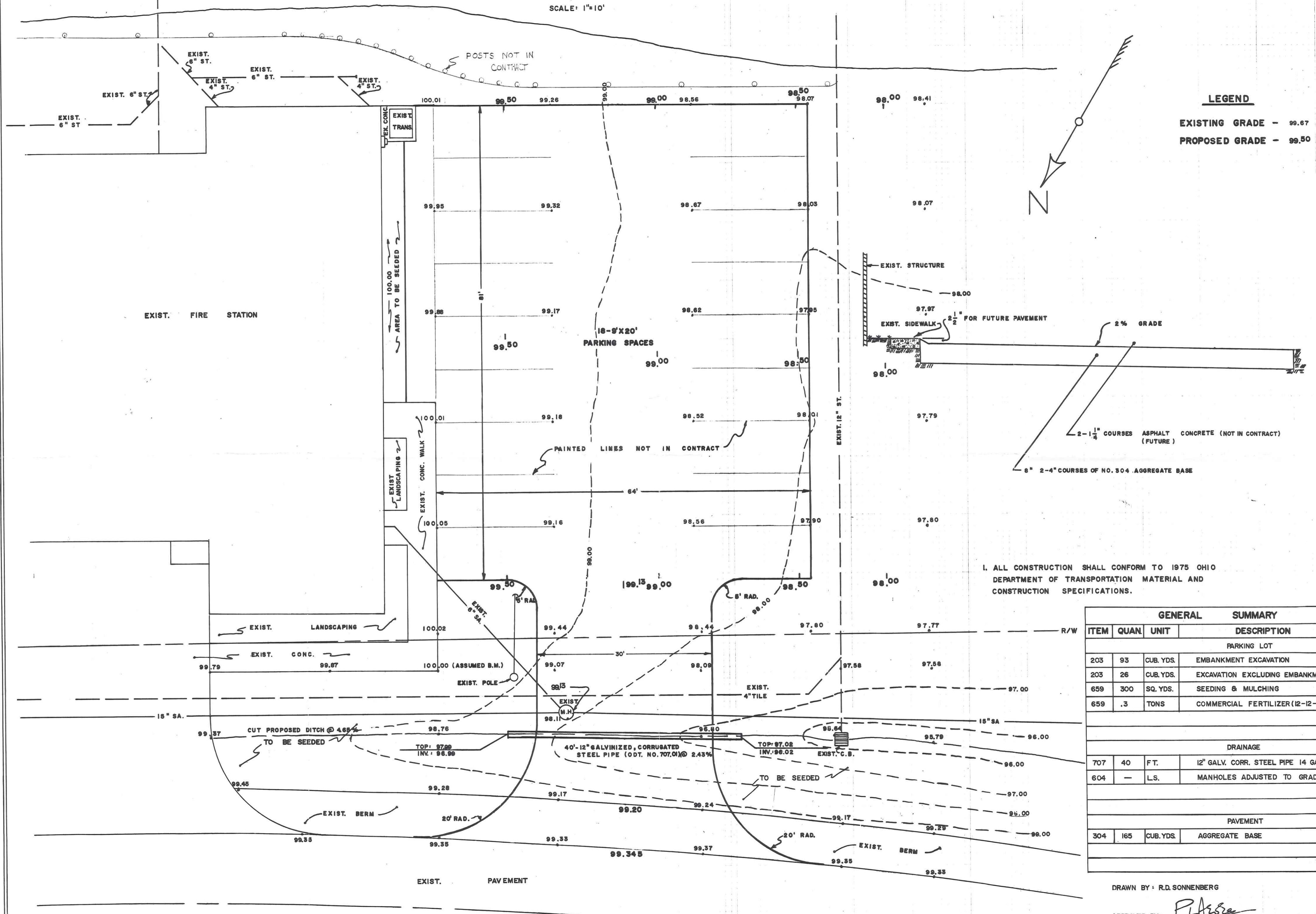

**LEGEND**

EXISTING GRADE - 99.67  
PROPOSED GRADE - 99.50

1. ALL CONSTRUCTION SHALL CONFORM TO 1975 OHIO DEPARTMENT OF TRANSPORTATION MATERIAL AND CONSTRUCTION SPECIFICATIONS.

GENERAL SUMMARY			
ITEM	QUAN	UNIT	DESCRIPTION
PARKING LOT			
203	93	CUB. YDS.	EMBANKMENT EXCAVATION
203	26	CUB. YDS.	EXCAVATION EXCLUDING EMBANKMENT
659	300	SQ. YDS.	SEEDING & MULCHING
659	.3	TONS	COMMERCIAL FERTILIZER (12-12-12)
DRAINAGE			
707	40	FT.	12" GALV. CORR. STEEL PIPE 14 GAUGE
604	-	L.S.	MANHOLES ADJUSTED TO GRADE
PAVEMENT			
304	165	CUB. YDS.	AGGREGATE BASE

DRAWN BY: R.D. SONNENBERG

APPROVED BY: *PLA*

DATE: APRIL 12, 1976 524 W. Washington